

SERVICE KIT

- CLESTA II / CLESTA eIII / SP-CLEO II / CREDIA G1 (1year service kit only) -

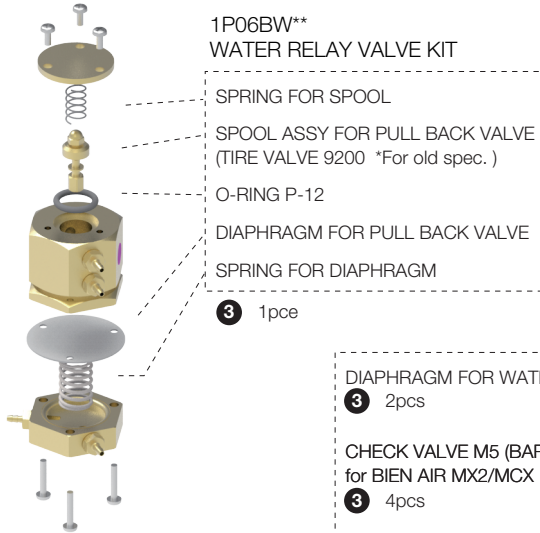

1P06BW**
WATER RELAY VALVE KIT

SPRING FOR SPOOL
SPOOL ASSY FOR PULL BACK VALVE
(TIRE VALVE 9200 *For old spec.)
O-RING P-12
DIAPHRAGM FOR PULL BACK VALVE
SPRING FOR DIAPHRAGM

3 1pce

DIAPHRAGM FOR WATER & AIR
3 2pcs
CHECK VALVE M5 (BARB FITTING 2.2)
for BIEN AIR MX2/MCX
3 4pcs
CHECK VALVE M5 (BARB FITTING 1.8)
for Turbine/Scaler
3 2pcs

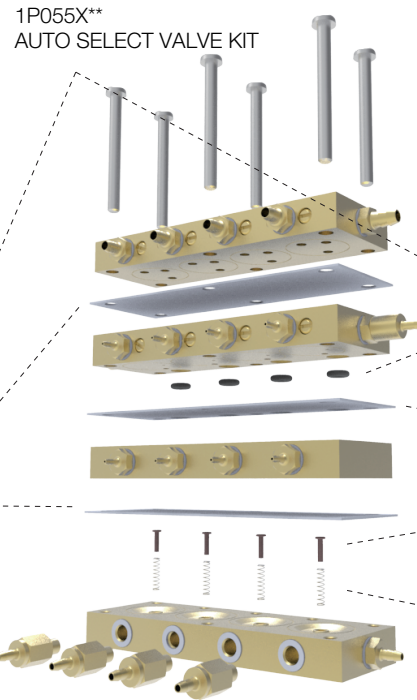

1P055X**
AUTO SELECT VALVE KIT

O-RING P-3
3 4pcs
DIAPHRAGM FOR PILOT AIR
3 1pce
POPPET FOR AUTO SELECT VALVE
3 4pce *For old spec.
SPRING FOR POPPET
3 4pcs *For old spec.



FARA71**
SPONGE FOR OIL MIST (NEW TYPE)
3 1pce



1A0BEH**
SPONGE FOR OIL MIST (OLD TYPE)
3 1pce



1E09J6**
PN8136 WASHER FOR WATER BOTTLE
1 3 1pce



1A025D**
DRAIN STRAINER
3 1pce



1A0GCE**
SOLID COLLECTOR FILTER (NEW TYPE)
1 3 1pce



FACA18**
SOLID COLLECTOR FILTER (OLD TYPE)
1 3 1pce

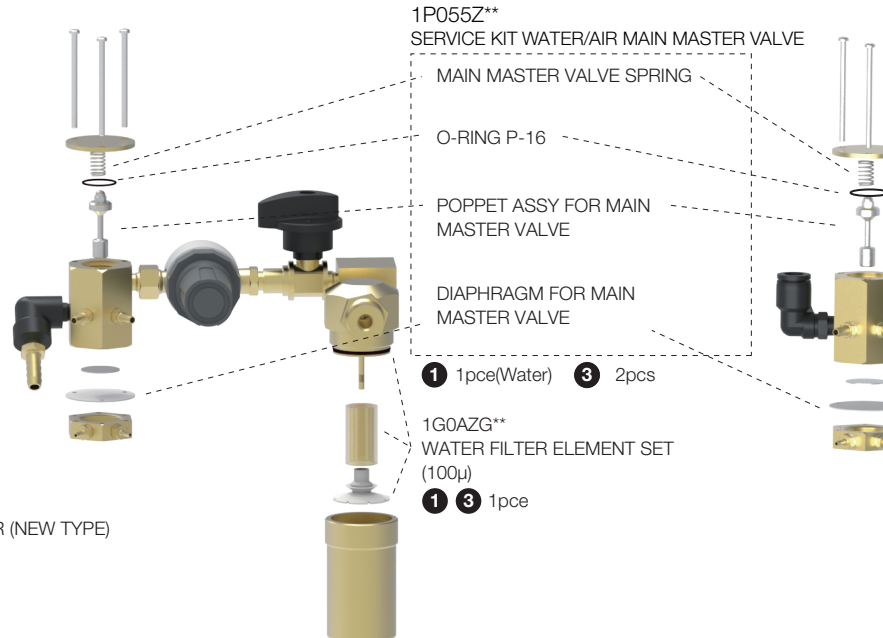

1P055Z**
SERVICE KIT WATER/AIR MAIN MASTER VALVE

MAIN MASTER VALVE SPRING
O-RING P-16
POPPET ASSY FOR MAIN
MASTER VALVE
DIAPHRAGM FOR MAIN
MASTER VALVE
1 1pce(Water) 3 2pcs
1G0AZG**
WATER FILTER ELEMENT SET
(100μ)
1 3 1pce



1G0AZH**
AIR FILTER ELEMENT SET
(5μ)
1 3 1pce

Each parts are included in below kit

1 1 year kit 3 3 years kit